

Winchelsea Beach Infiltration Plan

Appendix A – Status of Planned Actions - August 2025



from
**Southern
Water** 

The Southern Water logo consists of the words 'Southern' and 'Water' in a bold, sans-serif font, stacked vertically. To the right of the text is a graphic of three stylized, wavy blue lines representing water.

Reference Plan

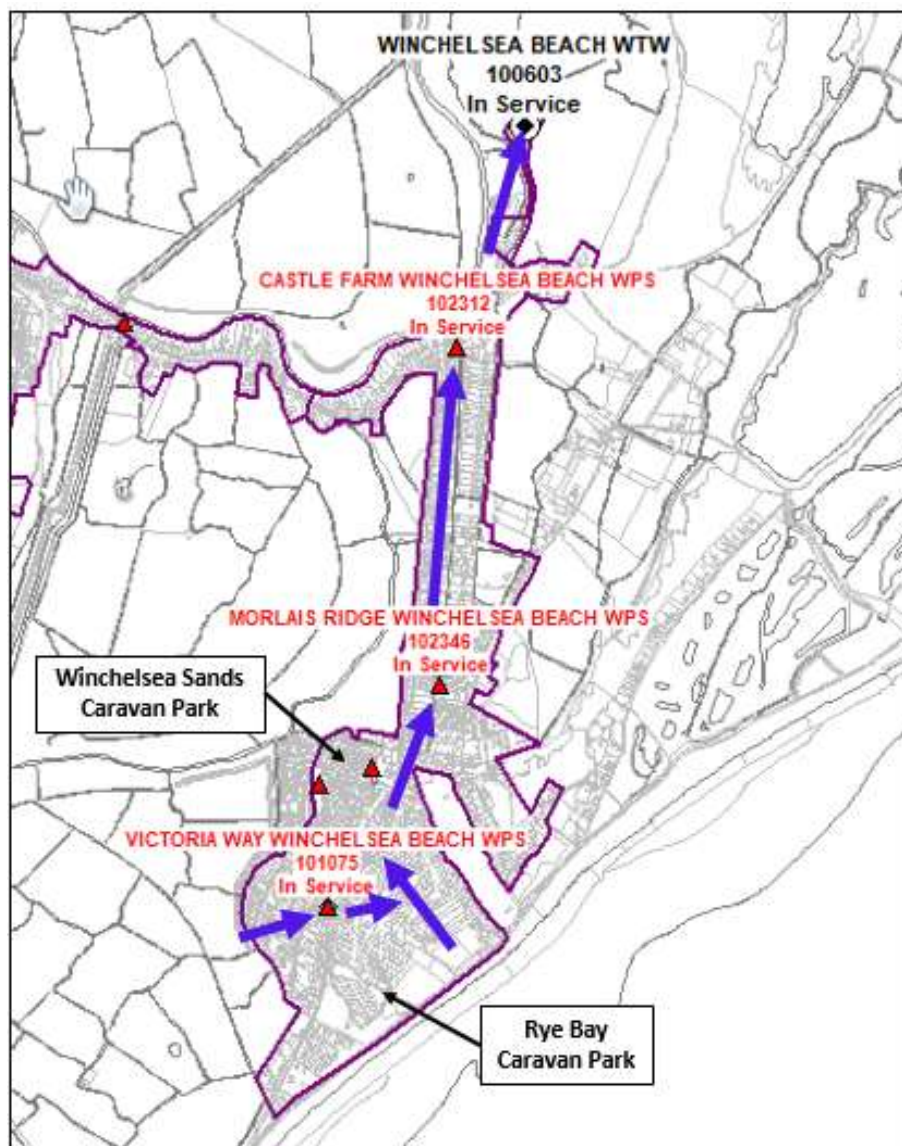

Action	Km
Length Surveyed (CCTV)	4.36
Length Surveyed (Electroscan)	1.62
Length with no work required	1.20
Length Sealed	3.32
Length to be sealed	0.474
Manholes sealed	4
Manholes to be sealed	1



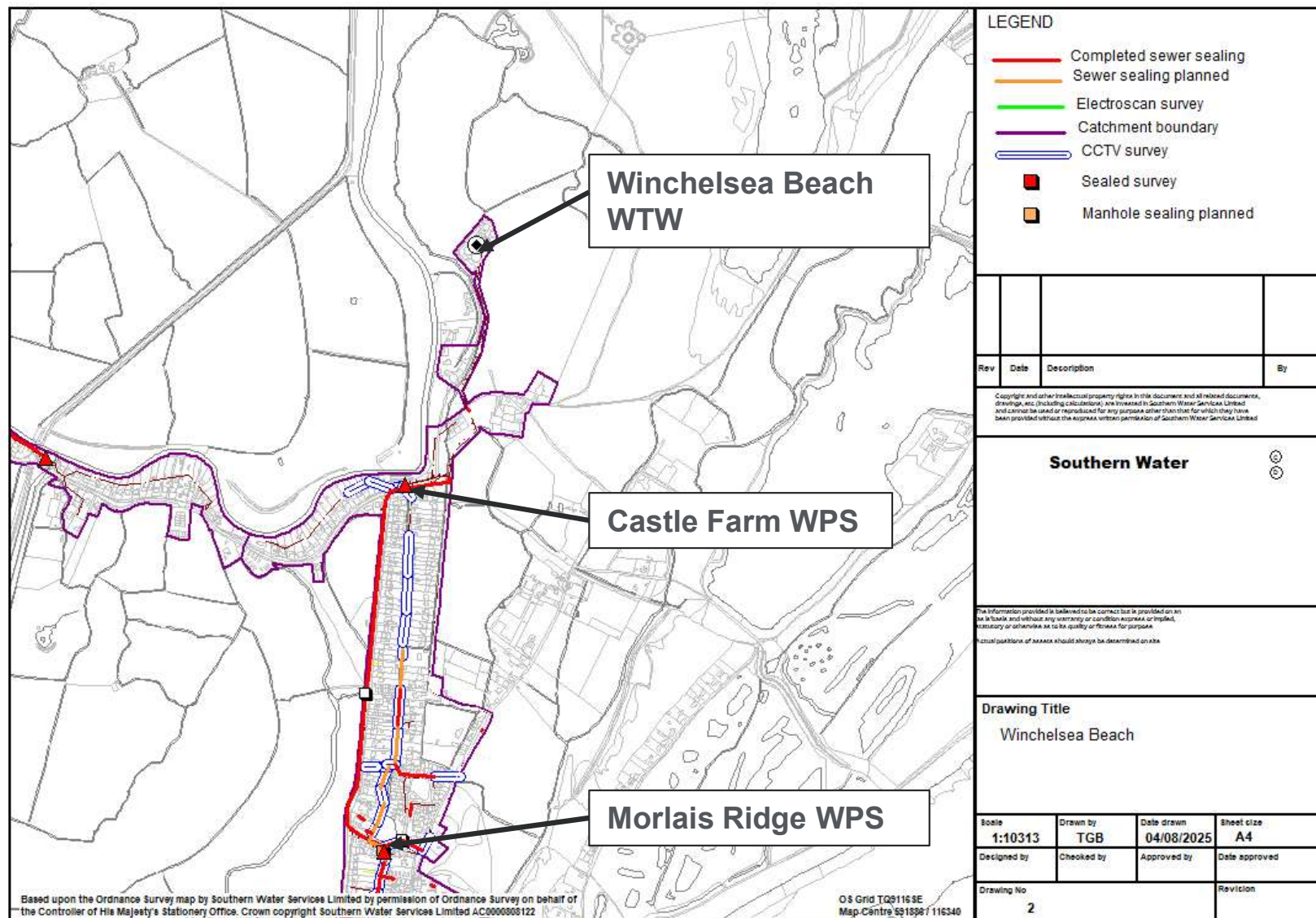

Detailed plan 1

Note – sewers shown as surveyed by cctv or Electroscan (green line) with no corresponding sealing work have been determined to not require rehabilitation. The use of storm harvester data will be used at some point in the future to target inspections and find infiltration



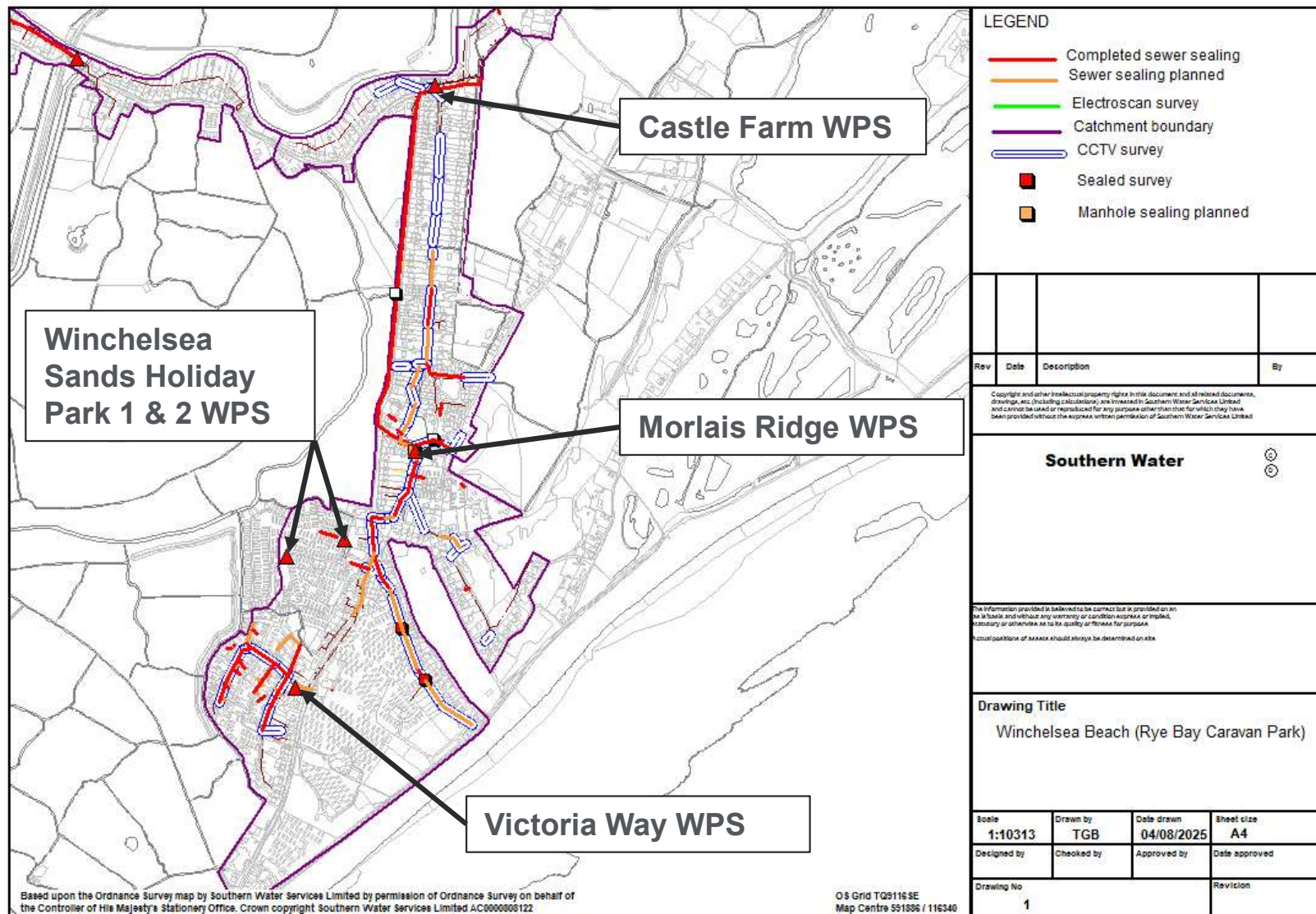

Detailed plan 2

Note – sewers shown as surveyed by cctv or Electroscan (green line) with no corresponding sealing work have been determined to not require rehabilitation. The use of storm harvester data will be used at some point in the future to target inspections and find infiltration

